

## Set Up

**1.** Assemble frame by connecting 4 curved tubes for the bottom level and 4 curved tubes for the top level. Using thumbscrews, attach the 4 vertical tubes to each corner.

**2.** Fit assembled frame over the case.

**3.** Unfold the top panel and place it on the top level of the frame.

**4.** Slip the cover over the frame and pull it down to the bottom. Align the seam at the top with the edges of the top panel.

**5.** Tip the table to the side and tighten the drawstring on the cover.

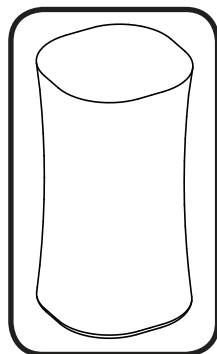
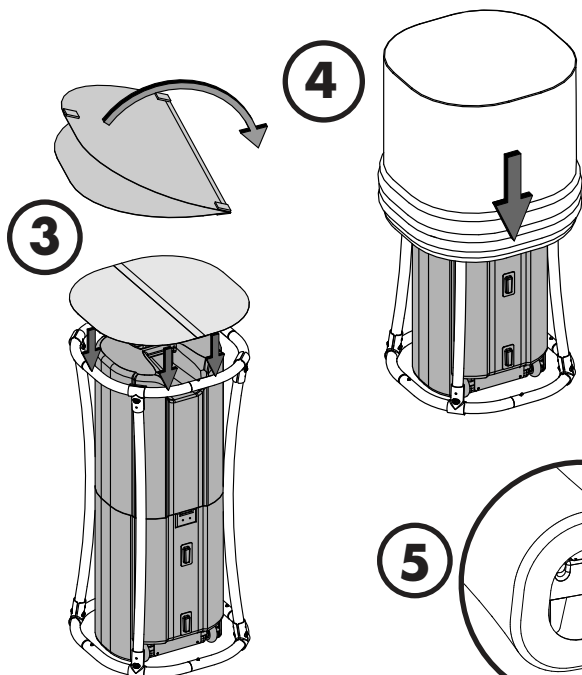

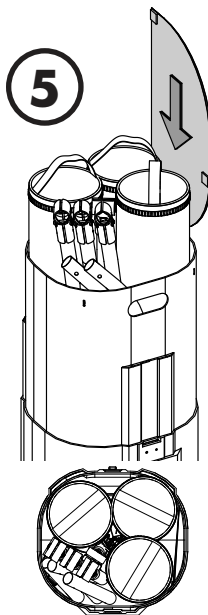
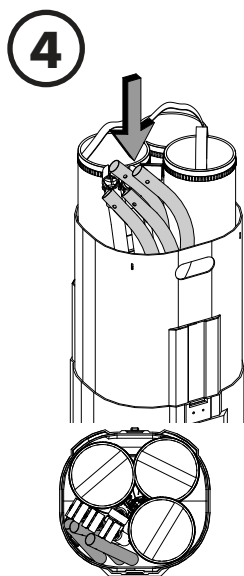
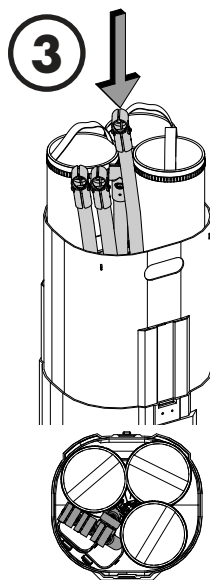
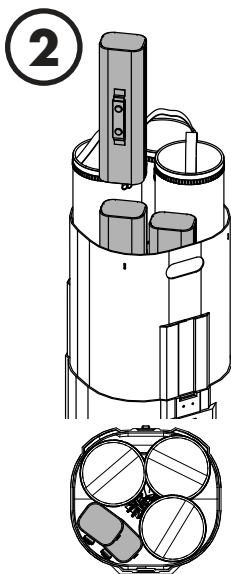
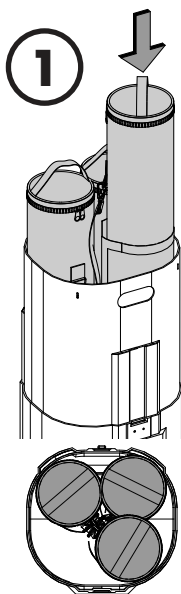

## Packing Order:

1. Banner Stand units in soft cases
2. Light packages in soft cases
3. Vertical Tubes
4. Horizontal Tubes
5. Folded Top Panel

Replace top of case and secure with strap.

